

# BECKMAN BUSINESS CENTER

STATE-OF-THE-ART BUSINESS PARK WITH HIGH-IMAGE  
BUILDINGS FOR SALE OR LEASE  
FULLERTON, CALIFORNIA



**Voit**  
REAL ESTATE SERVICES

**SETH DAVENPORT**  
714.935.2376  
sdavenport@voitco.com  
Lic #01413387

**MITCH ZEHNER**  
714.935.2307  
mzehner@voitco.com  
Lic #00882464

**MICHAEL HEFNER, SIOR**  
714.935.2331  
mhefner@voitco.com  
Lic #00857352

2400 E. Katella Avenue  
Suite 750  
Anaheim, CA 92806  
Lic#01991785

  
WESTERN REALCO



# PROJECT FEATURES

## STATE-OF-THE-ART BUSINESS PARK WITH HIGH-IMAGE BUILDINGS FOR SALE OR LEASE FULLERTON, CALIFORNIA

- New State-of-the-Art Corporate Headquarter Buildings
- 30' – 32' Minimum Warehouse Clearance
- True Dock-High Loading Doors
- ESFR Sprinkler Systems
- 100% Concrete Site and Truck Courts
- Private and Secured Truck Courts
- 52' x 60' Warehouse Bay Spacing
- Excellent Fullerton Location with Two-Street Access
- Desirable Street Visibility along Harbor Boulevard and Lambert Road
- Easy Access to the Orange (57) and Pomona (60) Freeways
- Access to Orange County, Los Angeles County and Inland Empire Markets



BUILDING NO.	BUILDING AREA	OFFICE	SITE AREA	SPRINKLER	CLEAR HEIGHT	PARKING	LOADING	YARD
Building 1	309,439 s.f.	6,265 s.f.	12.01 acres	ESFR K17 at 52 psi	32'	235 stalls	40 DH / 2 GL	Secured
Building 2	212,202 s.f.	6,265 s.f.	8.66 acres	ESFR K17 at 52 psi	32'	171 stalls	23 DH / 2 GL	Secured
Building 3	41,891 s.f.	4,559 s.f.	2.24 acres	ESFR K17 at 52 psi	30'	58 stalls	4 DH / 1 GL	None
Building 4	45,761 s.f.	4,559 s.f.	2.40 acres	ESFR K17 at 52 psi	30'	60 stalls	4 DH / 1 GL	None
Building 5	78,523 s.f.	4,559 s.f.	3.12 acres	ESFR K17 at 52 psi	30'	86 stalls	6 DH / 1 GL	Secured
Building 6	141,616 s.f.	6,265 s.f.	5.40 acres	ESFR K17 at 52 psi	32'	121 stalls	13 DH / 2 GL	Secured
Building 7	105,322 s.f.	6,265 s.f.	4.78 acres	ESFR K17 at 52 psi	30'	102 stalls	8 DH / 1 GL	Secured
Building 8	42,000 s.f.	To Suit	3.53 acres	N/A	16'	169 stalls	0 DH / 0 GL	None
<b>TOTAL</b>	<b>976,754 s.f.</b>		<b>44.29 acres</b>			<b>1,002 stalls</b>		

**Voit**  
REAL ESTATE SERVICES

**SETH DAVENPORT**  
714.935.2376  
sdavenport@voitco.com  
Lic #01413387

**MITCH ZEHNER**  
714.935.2307  
mzehner@voitco.com  
Lic #00882464

**MICHAEL HEFNER, SIOR**  
714.935.2331  
mhefner@voitco.com  
Lic #00857352

2400 E. Katella Avenue  
Suite 750  
Anaheim, CA 92806  
Lic#01991785



# PROPERTY HIGHLIGHTS

**STATE-OF-THE-ART BUSINESS PARK WITH HIGH-IMAGE BUILDINGS FOR SALE OR LEASE FULLERTON, CALIFORNIA**

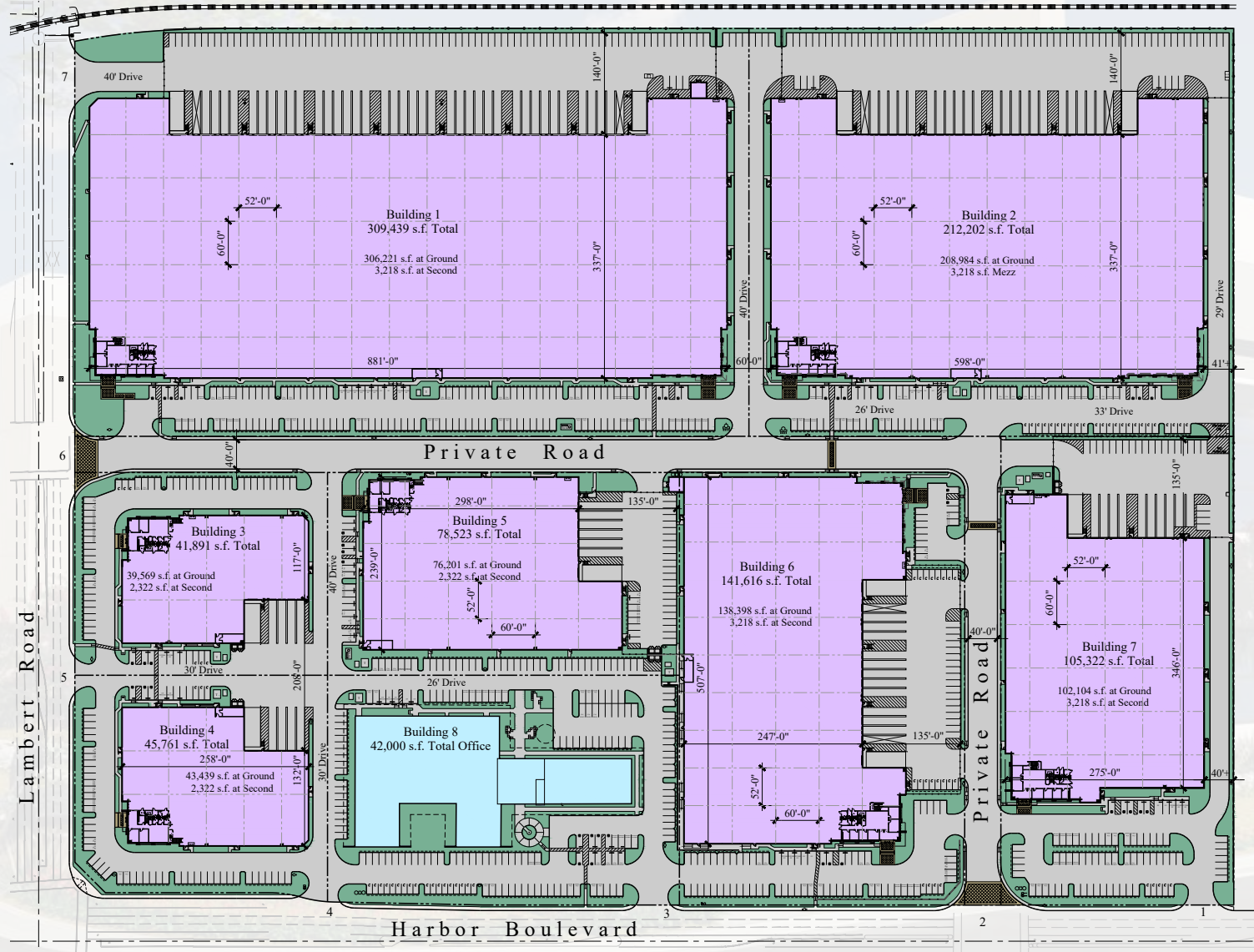

**Voit**  
REAL ESTATE SERVICES

**SETH DAVENPORT**  
714.935.2376  
sdavenport@voitco.com  
Lic #01413387

**MITCH ZEHNER**  
714.935.2307  
mzehner@voitco.com  
Lic #00882464

**MICHAEL HEFNER, SIOR**  
714.935.2331  
mhefner@voitco.com  
Lic #00857352

2400 E. Katella Avenue  
Suite 750  
Anaheim, CA 92806  
Lic#01991785





